

Vise-Top Stringing Tool

Construction

The Southwire Vise-Top Stringing Tool is molded from gray polyurethane. Polyurethane is incorporated into the Stringing Tool to reduce pulling forces and to increase the longevity of the tool. The tool is designed for easy use by utility personnel.

Features

- Stringing Tool molded from a polyurethane compound
- Lightweight and shatter resistant
- Designed to be operated either by hot stick or by hand
- Designed for low friction with both pulling rope and covered conductors
- Easy to install and remove

Application

The Vise-Top Stringing Tool is used in Vise-Top Insulators to facilitate the installation of the covered conductors. The Stringing Tool eliminates the need to use expensive and heavy sheaves while installing Covered Aerial MV systems. The Stringing Tool is easily installed and removed from the Vise-Top Insulator. Not recommended for bare conductors.

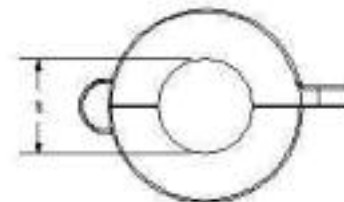
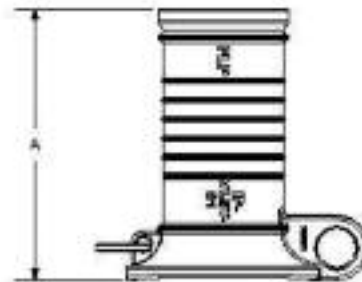

Southwire Stock #	Description	Hendrix Cat #	Dimensions (in)		Weight (lbs)
			A	B	
64991601	Vise-Top Stringing Tool	VTST-1	5	1.75	0.54